

CODE  
PAP 07.15

## Audio-HA® 90° Oval Head Partial Prosthesis

HA: Bioactive calcium hydroxylapatite ceramic

It replaces either the incus or the incudo-malleolar block.

The offset columella and the shape of the flange make it possible to see the head of the stapes while positioning the prosthesis and aligning the stapes-prosthesis axis.

The oval design of the flange prevents sharp corners from coming in contact with the tympanic membrane.

The thickness of the flange allows the creation of indentation for the handle of the malleus (use diamond bur under continuous irrigation).

The flange can be bound to the tympanic membrane by fibrine glue.

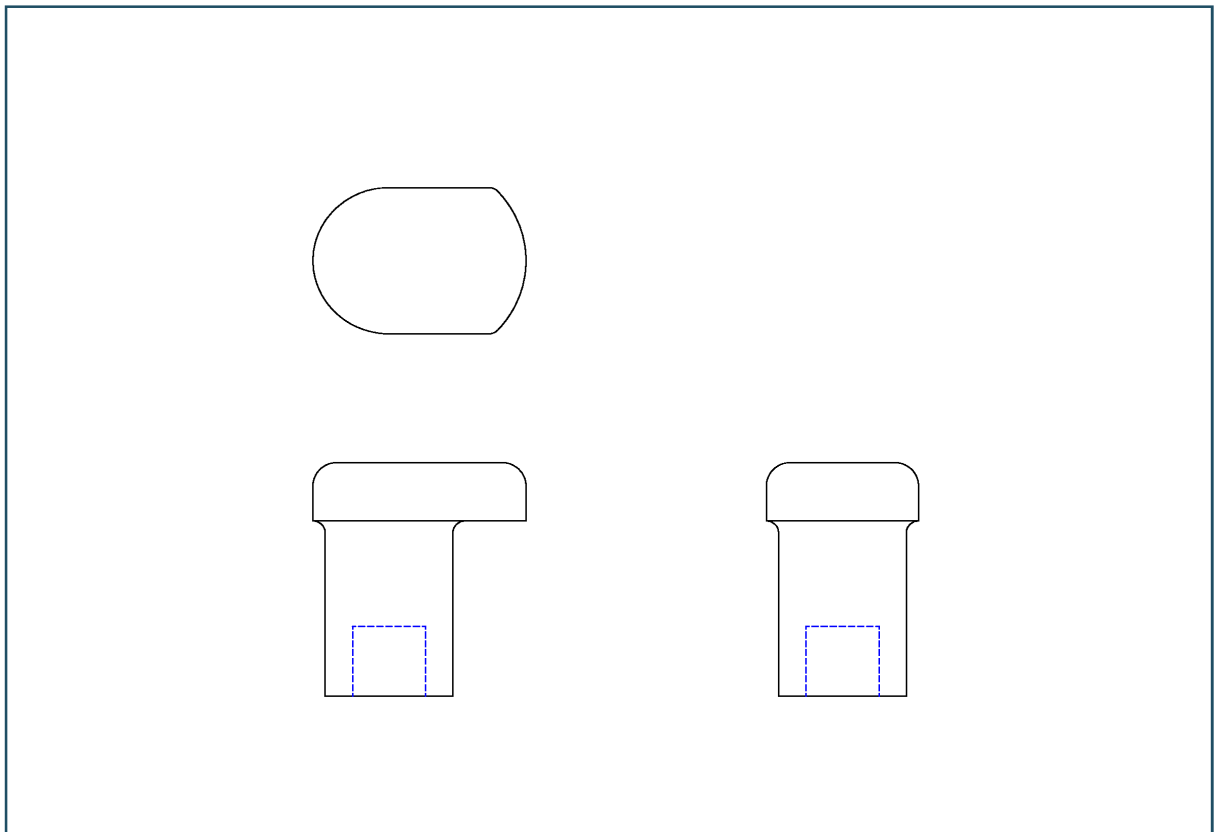

**Dimensions**

Total length (mm):  
3.00 - 3.50 - 4.00 - 4.50 - 5.00  
Flange maximum length: 4.00 mm  
Flange width: 2.50 mm  
Flange thickness: 0.80 mm  
Columella outside diameter: 2.00 mm  
Columella inside diameter: 1.20 mm

**Packaging**

Dispenser box containing 6 sterile,

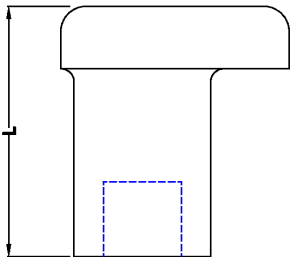
	Total length (L) mm	Code
	3.00	PAP 07.15.300
3.50	PAP 07.15.350	
4.00	PAP 07.15.400	
4.50	PAP 07.15.450	
5.00	PAP 07.15.500	

